

For Lease

**New
Construction**

- **Generous Tenant Improvement Allowance**
- **Ideal for Medical Use**



**107 Mont Blanc Blvd.
Dover, DE 19904**

For more information please contact:

David Heaney

Cell: (302)229.2242

E-mail: dth@healthcarefs.com

HFS Healthcare
Facilities
Solutions

**Office: (302)995.6805
www.healthcarefs.com**

This information has been obtained from sources believed to be reliable but has not been verified. NO WARRANTY OR REPRESENTATION, EXPRESS OR IMPLIED, IS MADE AS TO THE CONDITION OF THE PROPERTY (OR PROPERTIES) REFERENCED HEREIN OR AS TO THE ACCURACY OR COMPLETENESS OF THE INFORMATION CONTAINED HEREIN, AND SAME IS SUBMITTED SUBJECT TO ERRORS, OMISSIONS, CHANGE OF PRICE, RENTAL OR OTHER CONDITIONS, WITHDRAWAL WITHOUT NOTICE, AND TO ANY SPECIAL LISTING CONDITIONS IMPOSED BY THE PROPERTY OWNER(S). ANY PROJECTIONS, OPINIONS OR ESTIMATES ARE SUBJECT TO UNCERTAINTY AND DO NOT SIGNIFY CURRENT OR FUTURE PROPERTY PERFORMANCE.

107 Mont Blanc Blvd. Dover, DE 19904



Property Highlights:

- ✓ **Medical Office Building (1,500 SF +/- Shell Space)**
- ✓ **New Construction**
- ✓ **Generous Tenant Improvement Allowance**
- ✓ **Located in High Visibility Location**
- ✓ **Ample Parking**
- ✓ **Convenient Location - Easily Accessible - Minutes from Route 1**

For more information please contact:

David Heaney

Cell: (302)229.2242

E-mail: dth@healthcarefs.com



Office: (302)995.6805
www.healthcarefs.com

This information has been obtained from sources believed to be reliable but has not been verified. NO WARRANTY OR REPRESENTATION, EXPRESS OR IMPLIED, IS MADE AS TO THE CONDITION OF THE PROPERTY (OR PROPERTIES) REFERENCED HEREIN OR AS TO THE ACCURACY OR COMPLETENESS OF THE INFORMATION CONTAINED HEREIN, AND SAME IS SUBMITTED SUBJECT TO ERRORS, OMISSIONS, CHANGE OF PRICE, RENTAL OR OTHER CONDITIONS, WITHDRAWAL WITHOUT NOTICE, AND TO ANY SPECIAL LISTING CONDITIONS IMPOSED BY THE PROPERTY OWNER(S). ANY PROJECTIONS, OPINIONS OR ESTIMATES ARE SUBJECT TO UNCERTAINTY AND DO NOT SIGNIFY CURRENT OR FUTURE PROPERTY PERFORMANCE.

107 Mont Blanc Blvd. Dover, DE 19904

Details:

- **Type:** Office
- **Subtype:** Medical
- **Available:** Shell Space
- **Minimum Divisible:** 1,500 SF +/-
- **Total SF Available:** 1,500 SF +/-

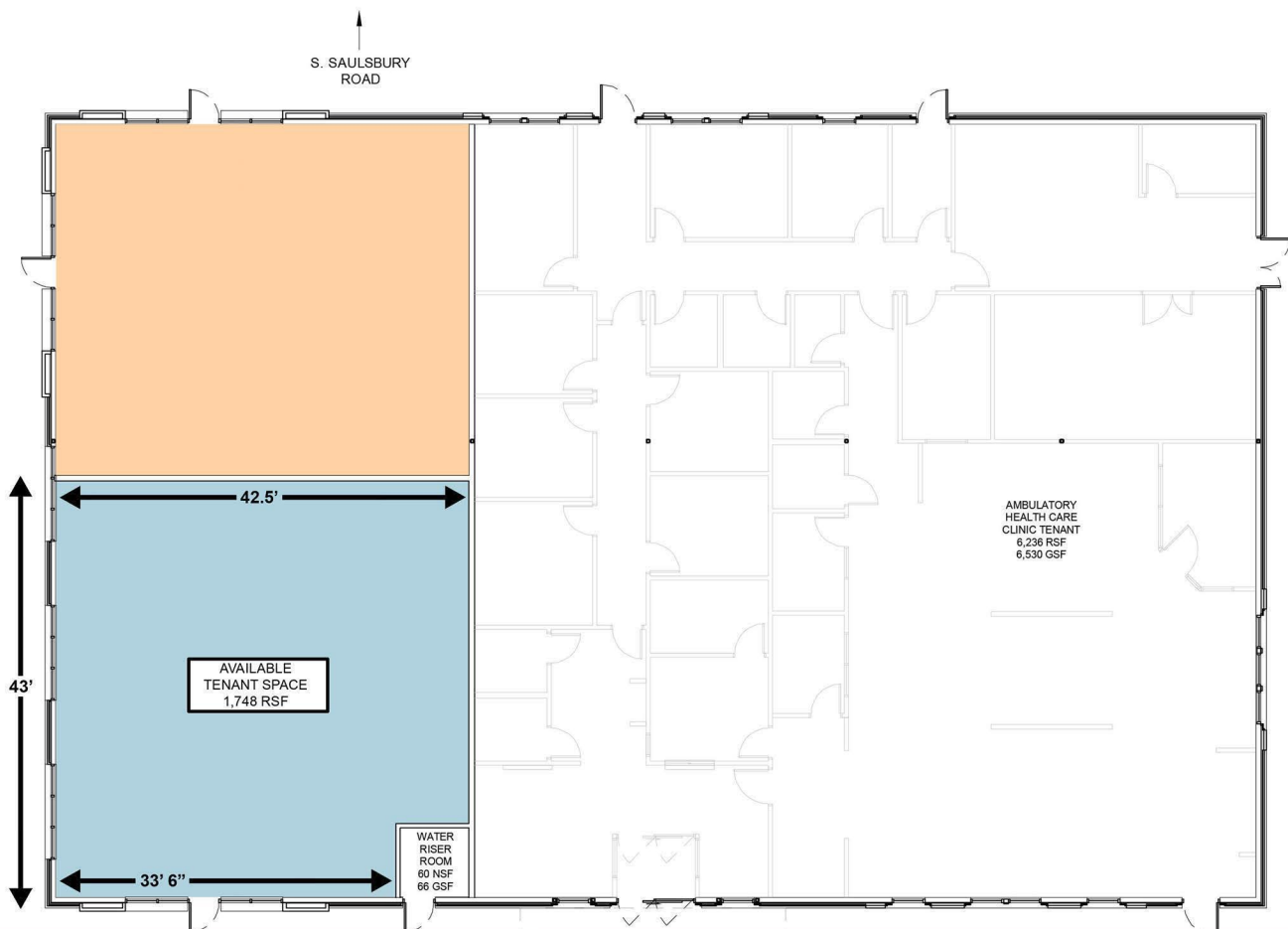

For more information please contact:

David Heaney

Cell: (302)229.2242

E-mail: dth@healthcarefs.com

HFS Healthcare
Facilities
Solutions

Office: (302)995.6805
www.healthcarefs.com

This information has been obtained from sources believed to be reliable but has not been verified. NO WARRANTY OR REPRESENTATION, EXPRESS OR IMPLIED, IS MADE AS TO THE CONDITION OF THE PROPERTY (OR PROPERTIES) REFERENCED HEREIN OR AS TO THE ACCURACY OR COMPLETENESS OF THE INFORMATION CONTAINED HEREIN, AND SAME IS SUBMITTED SUBJECT TO ERRORS, OMISSIONS, CHANGE OF PRICE, RENTAL OR OTHER CONDITIONS, WITHDRAWAL WITHOUT NOTICE, AND TO ANY SPECIAL LISTING CONDITIONS IMPOSED BY THE PROPERTY OWNER(S). ANY PROJECTIONS, OPINIONS OR ESTIMATES ARE SUBJECT TO UNCERTAINTY AND DO NOT SIGNIFY CURRENT OR FUTURE PROPERTY PERFORMANCE.

107 Mont Blanc Blvd. Dover, DE 19904

Demographics:

- **Population: 38,079**
- **Households: 13,639**

Notable Neighbors:

- **The Little School at Kids Cottage**

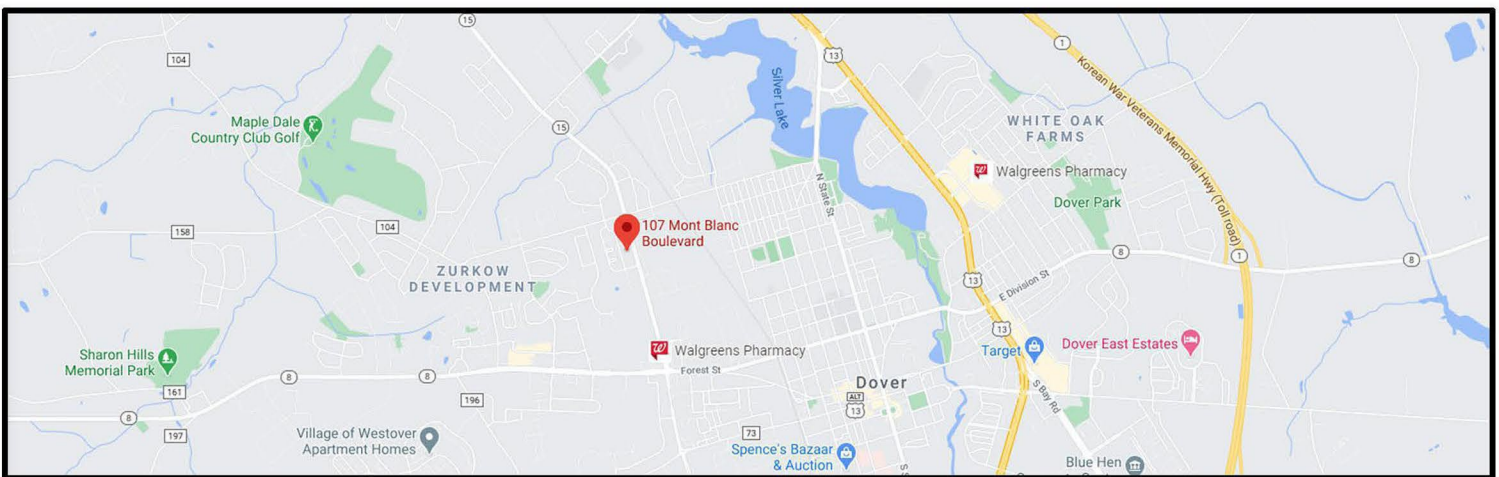
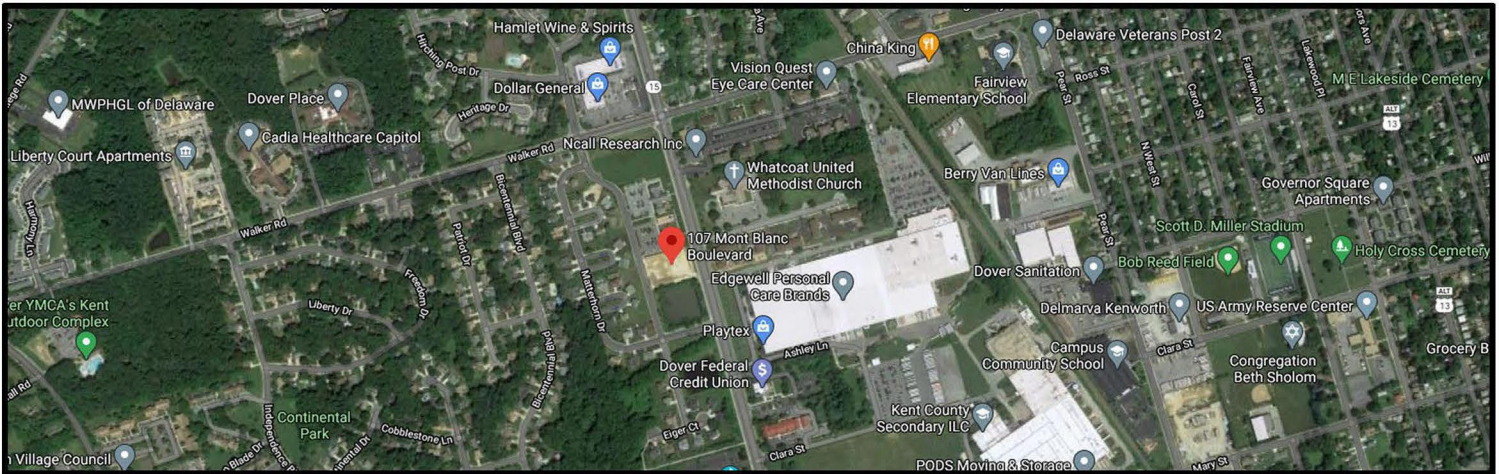

For more information please contact:

David Heaney

Cell: (302)229.2242

E-mail: dth@healthcarefs.com

HFS Healthcare
Facilities
Solutions

Office: (302)995.6805

www.healthcarefs.com

This information has been obtained from sources believed to be reliable but has not been verified. NO WARRANTY OR REPRESENTATION, EXPRESS OR IMPLIED, IS MADE AS TO THE CONDITION OF THE PROPERTY (OR PROPERTIES) REFERENCED HEREIN OR AS TO THE ACCURACY OR COMPLETENESS OF THE INFORMATION CONTAINED HEREIN, AND SAME IS SUBMITTED SUBJECT TO ERRORS, OMISSIONS, CHANGE OF PRICE, RENTAL OR OTHER CONDITIONS, WITHDRAWAL WITHOUT NOTICE, AND TO ANY SPECIAL LISTING CONDITIONS IMPOSED BY THE PROPERTY OWNER(S). ANY PROJECTIONS, OPINIONS OR ESTIMATES ARE SUBJECT TO UNCERTAINTY AND DO NOT SIGNIFY CURRENT OR FUTURE PROPERTY PERFORMANCE.